

REFER TO DWG. No. 1520

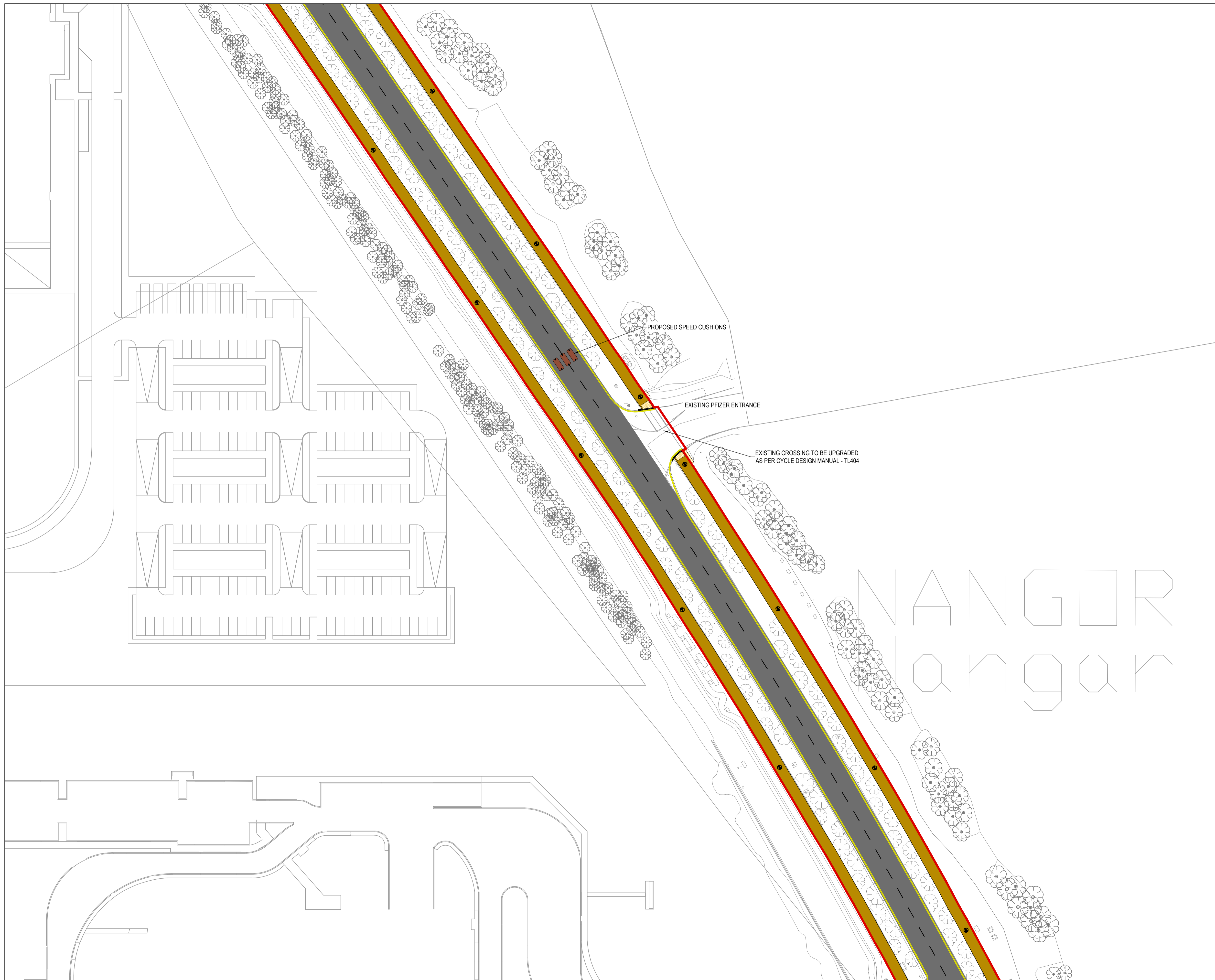

REFER TO DWG. No. 1522

DRAWING IS PRODUCED USING THE IRISH TRANSVERSE MERCATOR (ITM) GEOGRAPHIC COORDINATE SYSTEM

A1



LEGEND:

- PROPOSED CARRIAGEWAY UPGRADES
- PROPOSED SHARED PATH
- PROPOSED FOOTPATH
- PROPOSED RAISED PLATFORM / RAMP
- PROPOSED TACTILE PAVING (BUFF)
- PROPOSED TACTILE PAVING (RED)
- COURDROY HAZARD WARNING TACTILE PAVING (BUFF - ROUND TOP)
- PROPOSED SEGREGATED SHARED CYCLE TRACK / FOOTWAY TACTILE PAVING (BUFF - SQUARE TOP)
- PROPOSED BELISHA BEACON LOCATION
- SECTION 38 BOUNDARY

Rev	Description	Drawn	Checked	Date
PL01	SECTION 38 ISSUE	KT	DRL	XX/XX/XX

Clifton Scannell Emerson Associates Limited
 Consulting Engineers,
 3rd Floor, The Highline,
 Bakers Point, Pottery Road,
 Dun Laoghaire, Co. Dublin,
 Ireland, A96 KW29

T: +353 1 288 5006
 F: +353 1 283 3466
 E: info@csea.ie
 W: www.csea.ie

SOUTH DUBLIN COUNTY COUNCIL

Client

PROPOSED UPGRADE SCHEME FOR GC BUSINESS PARKS

Project

PROPOSED LAYOUT SHEET 11 OF 14

Dwg. Title

KT DRL MAR. 2026

Drawn By **Checked By** **Date**

Project Code	Originator	Zonal Phase	Level	Type	Role	Dwg. No.
24_158 - CSE - GEN - XX - DR - C - 1521						

S2 SUITABLE FOR INFORMATION 1:500

Status Code Suitability Description Scale @ A1

PL01 PLANNING **24_158**

Revision Project Status CSEA Job No.

OSI Licence No.: EN 0042424 © OSI/GOVERNMENT OF IRELAND