

REFER TO DWG. No. 1521

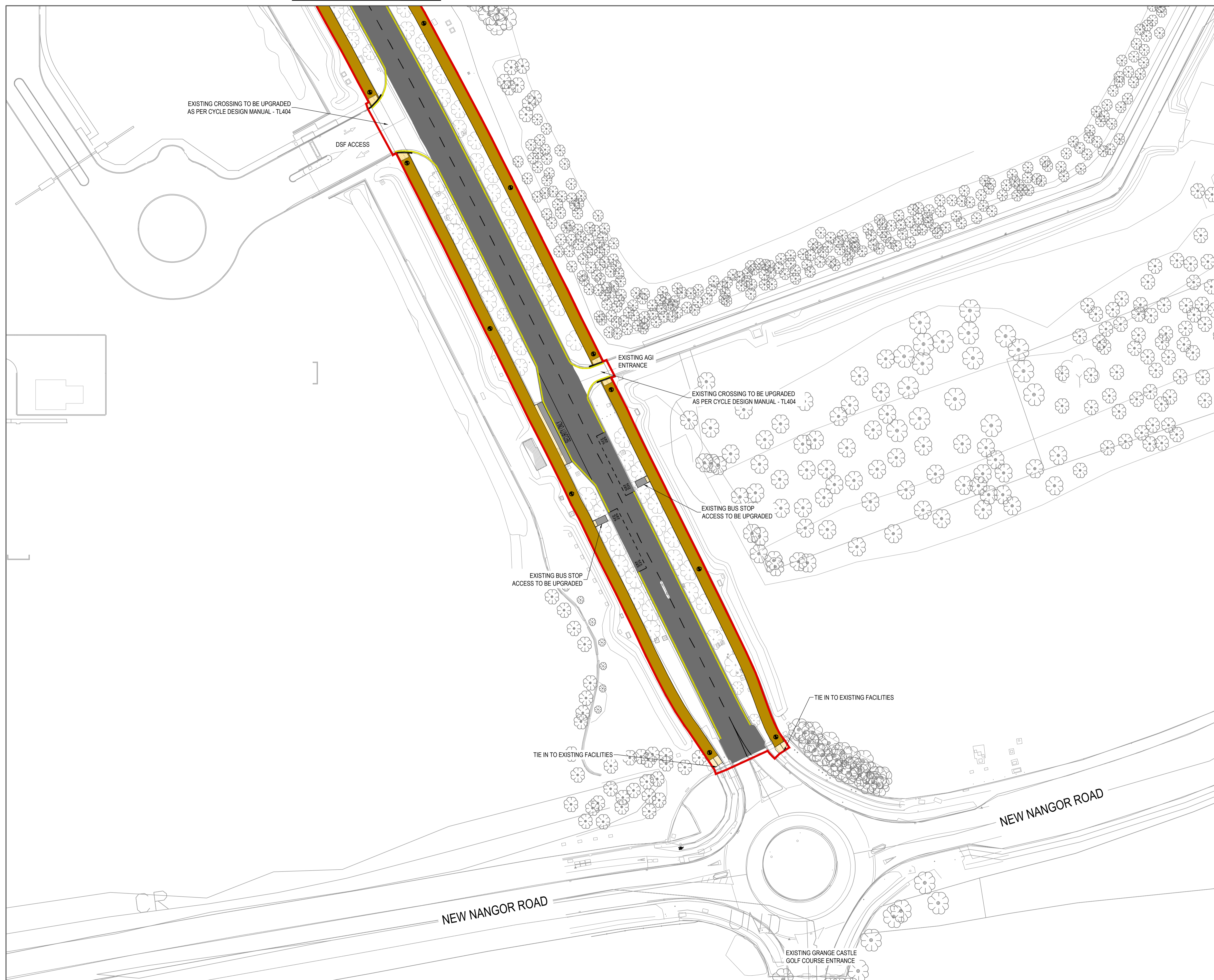

DRAWING IS PRODUCED USING THE IRISH TRANSVERSE MERCATOR (ITM) GEOGRAPHIC COORDINATE SYSTEM

A1



**LEGEND:**

PROPOSED CARRIAGEWAY UPGRADES	
PROPOSED SHARED PATH	
PROPOSED FOOTPATH	
PROPOSED RAISED PLATFORM / RAMP	
PROPOSED TACTILE PAVING (BUFF)	
PROPOSED TACTILE PAVING (RED)	
COURDROY HAZARD WARNING TACTILE PAVING (BUFF - ROUND TOP)	
PROPOSED SEGREGATED SHARED CYCLE TRACK / FOOTWAY TACTILE PAVING (BUFF - SQUARE TOP)	
PROPOSED BELISHA BEACON LOCATION	
SECTION 38 BOUNDARY	

Rev	Description	Drawn	Checked	Date
PL01	SECTION 38 ISSUE	KT	DRL	XX/XX/XX

**Clifton Scannell Emerson Associates**  
 Consulting Engineers,  
 3rd Floor, The Highline,  
 Bakers Point, Pottery Road,  
 Dun Laoghaire, Co. Dublin,  
 Ireland, A96 KW29

T: +353 1 288 5006  
 F: +353 1 283 3466  
 E: info@csea.ie  
 W: www.csea.ie

Client: SOUTH DUBLIN COUNTY COUNCIL  
 Project: PROPOSED UPGRADE SCHEME FOR GC BUSINESS PARKS  
 Dwg. Title: PROPOSED LAYOUT SHEET 12 OF 14  
 Drawn By: KT, Checked By: DRL, Date: MAR. 2026

Project Code	Originator	Zonal Phase	Level	Type	Role	Dwg. No.
24_158	CSE	GEN	XX	DR	C	1522

S2 SUITABLE FOR INFORMATION 1:500  
 Status Code: S2, Suitability Description: SUITABLE FOR INFORMATION, Scale @ A1  
 PL01 PLANNING 24\_158  
 Revision: PL01, Project Status: PLANNING, CSEA Job No.: 24\_158  
 OSI Licence No.: EN 0042424 © OSI/GOVERNMENT OF IRELAND